

#82WC SAMPLING STATION - GENERAL SPECIFICATION

GENERAL HYDRANT SPECIFICATIONS	
MAXIMUM OPERATING PRESSURE:	220 PSI
INLET MATERIALS:	316 STAINLESS STEEL
ENCLOSURE COLOR:	BLUE
CONTINUOUSLY WETTED MATERIALS:	303 S.S., 304 S.S., 316 S.S., REINFORCED TEFLON
DEPTH OF BURY:	1'-3" STANDARD
WEIGHT:	~64 - MAY VARY

ITEM	DESCRIPTION	NOTES
1	UV RESISTANT LOCKABLE LID	
2	MAIN BLOW-OFF S.S. BALL VALVE	
3	MOUNTING BRACKET	
4	THREADED S.S. BLOW-OFF OUTLET	
5	S.S. SAMPLING POINT	
6	FREEZE PROTECTION VALVE	
7	FREEZE PROTECTION/SAMPLING S.S. BALL VALVE	
8	MAIN S.S. WATERWAY	
9	LOCKING TAB	
10	VALVE BOX	BY OTHERS
11	COUPLING	BY OTHERS
12	PIPE NIPPLE	BY OTHERS
13	SHUTOFF VALVE OR CORP STOP	BY OTHERS
14	3" PVC DRAIN	BY OTHERS

Product Ordering Guide											
MODEL#	82	-	#	-	#	-	A	-	A	-	BL
SUBSECTION	1		2		3		4		5		6
SUBSECTION DESCRIPTION	MODEL #		OPTIONS		DESCRIPTIONS						
MODEL	1		82WC		SAMPLING STATION						
SIZE	2										
DEPTH OF BURY	3										
INLET OPTIONS	4										
BLOW-OFF OUTLET OPTIONS	5										
SAMPLING POINT OPTIONS	6										
BOLLARD ENCLOSURE OPTIONS	7										

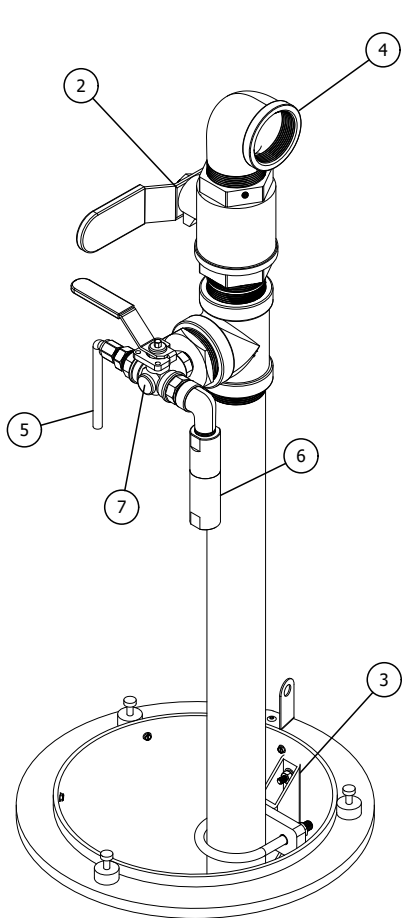

W.2 #82WC-2 VALVES ISO
Scale: 1-1/2"=1'

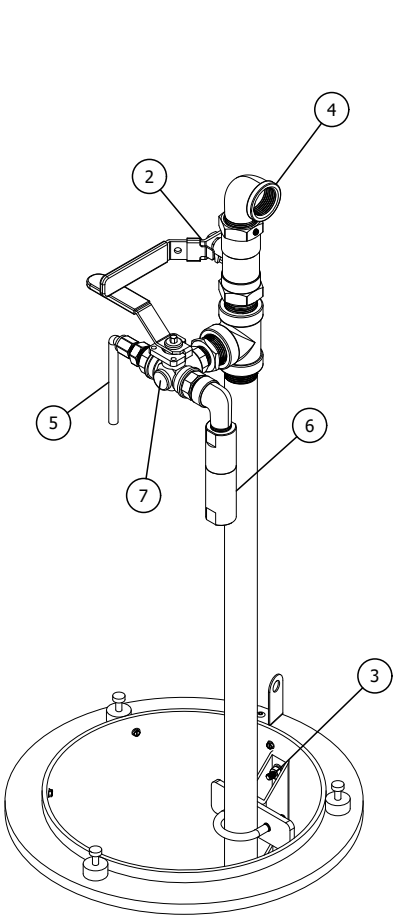

W.1 #82WC-1 VALVES ISO
Scale: 1-1/2"=1'

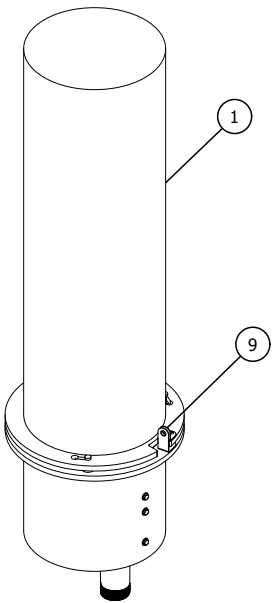

E1 BOLLARD ENCLOSURE - ISO
Scale: 3/4"=1'

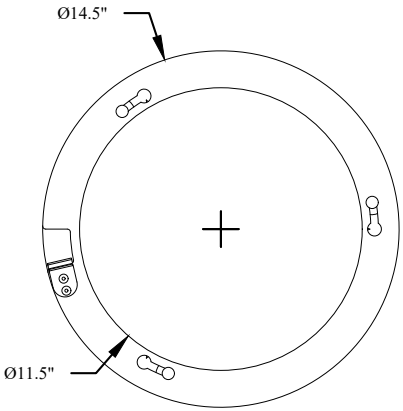

E2 ENCLOSURE - PLAN DIMS
Scale: 1 1/2"=1'

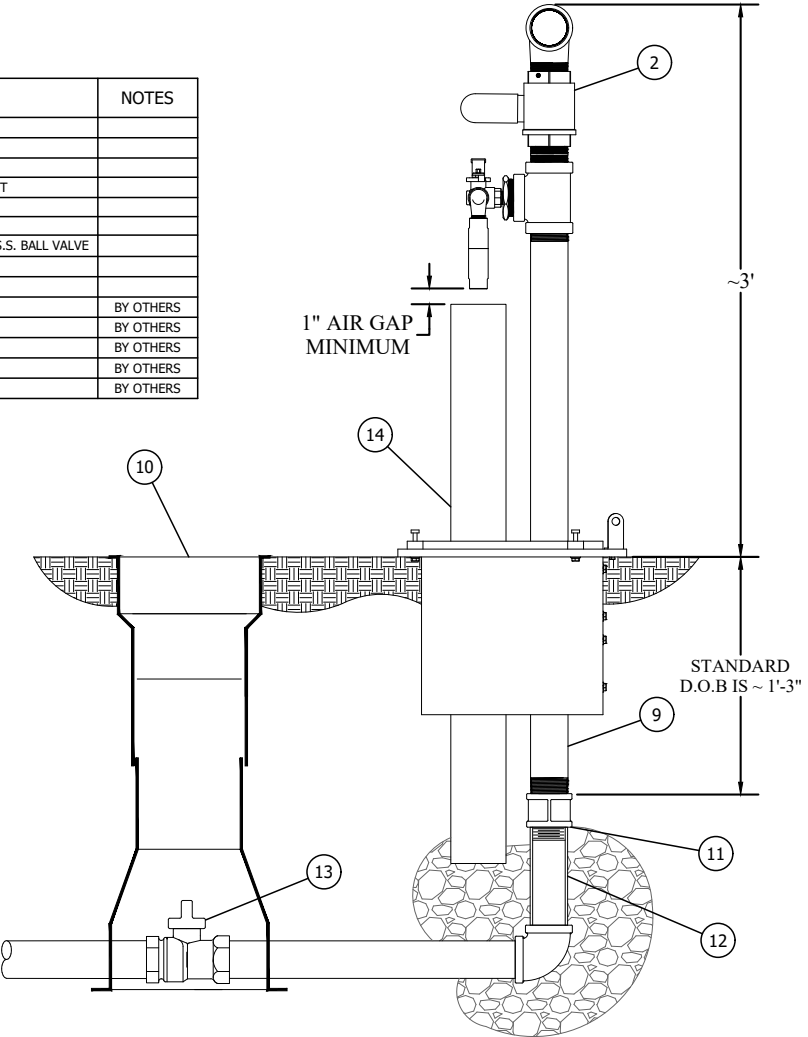

1 #82WC STANDARD INSTALL VIEW
Scale: 1" = 1'

#82WC SAMPLING STATION shall be installed in the following location(s): _____

#82WC Freeze Proof Sampling Station shall be a standard 15" depth of bury, with a MIP inlet and FNPT threaded blow-off discharge according to the size specified. Station shall come standard with a Stainless Steel sampling point plumbed before main discharge for sampling. A main Stainless Steel blow-off valve shall control the flow of water for the main discharge. The unit shall be fully enclosed in a UV resistant lockable cover allowing for 360 degree access to the station and when open, the station shall require no key for operation. All water flow must be thru Stainless Steel and all operational parts shall be serviceable from above ground without any digging. A temperature activated water relief valve shall maintain a controlled water temperature with the waterway by opening the valve port when the water temperature reaches 35°F and remain open until warmer water reaches the port, thus creating a non-freezing environment. The freeze proof cycle shall repeat as often as necessary to prevent freezing. Station shall be set in crushed stone to allow for proper drainage of hydrant freeze protection valve. Recommendation of the AWWA should be followed when installing the hydrant.

Unit model # shall be 82WC-#-#-#-A-A-A-BL as specified in the product ordering guide as manufactured by Kupferle Foundry Company, St. Louis MO, or approved equal.

OPERATIONAL NOTES:

- 1.) MAIN BLOW-OFF VALVE SHOWN IN THE OFF (FREEZE PROTECTION) POSITION.
- 2.) SAMPLING VALVE SHOWN IN THE OFF (FREEZE PROTECTION) POSITION.
- 3.) DRAIN SHALL BE INSTALLED TO ALLOW THE FREEZE PROTECTION VALVE TO DRAIN BELOW THE FROST LINE. THE EXACT AMOUNT OF WATER DISPENSED DEPENDS ON AMBIENT AIR TEMPERATURE, MAKE UP WATER TEMPERATURE, AND DURATION OF THE COLD SPELL.
 - @ 20 °F - APPROXIMATELY 13 GALLONS PER DAY
 - @ -10 °F - APPROXIMATELY 42 GALLONS PER DAY
- 4.) THE WARM CLIMATE MODEL IS INTENDED TO USE THE FREEZE PROTECTION FEATURE TO PREVENT ANY SORT OF CRITICAL DAMAGE TO THE SAMPLING STATION. THE WATER FLOW PATH FOR THE FREEZE PROTECTION VALVE REFLECTS THIS.
- 5.) EXTREME CONDITIONS CAN AFFECT THE STATION ADVERSELY, AND IF LOCATED IN AN AREA WHERE MOVING WATER FREQUENTLY FREEZES OR THE SUPPLY WATER BELOW GROUND MIGHT NOT REACH 40°F, KUPFERLE RECOMMENDS A DRY BARREL STYLE SAMPLING STATION.

NOTES	
A	PIPING BY OTHERS
B	FLUSH LINE BEFORE INSTALLATION OF THE HYDRANT
C	GROUND LINE MAY VARY
D	IN CORROSIVE SOLIDS THE BURIED PIPE SHOULD BE PREPPED FOR ADDITIONAL RESISTANCE TO CORROSION. KUPFERLE RECOMMENDS SPRAYING ALL UNDERGROUND PIPING AND FITTINGS WITH BITUMINOUS SPRAY TAR, ALLOWING PROPER TIME TO DRY AND WRAPPING THE PARTS.

#82WC GENERAL SPEC SHEET

INITIALS		DATE
DRAWN	DCL	3/18/21
APPROVED	DCL	1/30/23
MODIFIED	KJW	1/30/23
SHEET SIZE	SCALE	SCALE
B (11x17)	VARIES	VARIES



2511 NORTH 9TH STREET
ST. LOUIS, MO 63102
1-800-231-3990
FAX 314-231-2820
www.hydrants.com