

#9700-A PORTABLE AUTOMATIC FLUSHING DEVICE SPEC SHEET

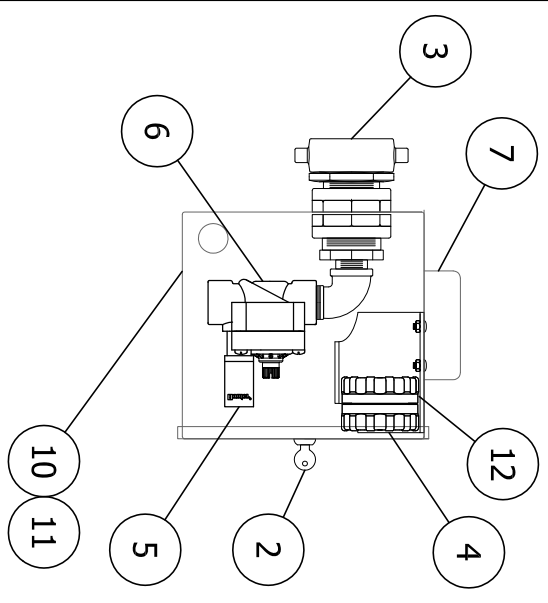

1 STANDARD FLUSHER
Scale: 1-1/2"=1'-0"

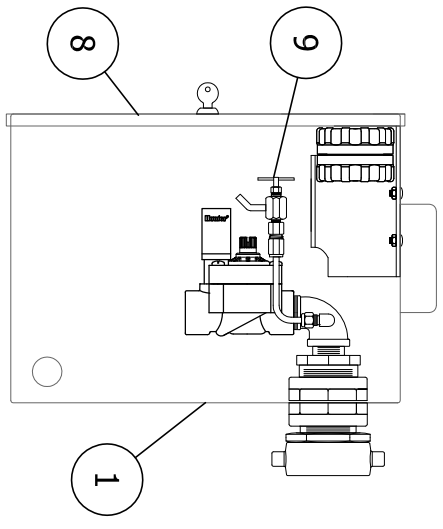

2 FLUSHER WITH SAMPLING
Scale: 1-1/2"=1'-0"

NOTE 1

A 2-1/2" NST Swivel connection shall lead into a 1" automatic flushing valve. The flushing valve shall control the flow of water through the hydrant and its diaphragm with the extension and retraction of a DC latching solenoid and have a 150 PSI rating. Each unit shall be furnished with a stand-alone valve controller. The valve controller will not require a second hand-held device for programming. Controller must have minimum of 12 possible flushing cycles per day. Controller shall be submersible to 12 feet, and operate with a 9 volt battery, and have resin-sealed electrical components. The solenoid shall have no loose parts when removed from the valve.

All components shall be housed in a lockable powder coated (RED or YELLOW) aluminum enclosure, with 3/4" perforations in the floor to diffuse flushing water.

A removable floor plate shall allow access to a 1" FIP outlet if needed.

Optional collar lock shall cover the 2-1/2" swivel to prevent any tampering with the device.

Optional diffuser shall be available and able to installed thru removable access plate to allow directions flow of flushed water.

Unit model # shall be 9700-A as manufactured by Kupferle Foundry Company, St. Louis MO, or approved equal.

#9700-A AUTOMATIC FLUSHING DEVICE TO BE INSTALLED AT THE FOLLOWING LOCATIONS:

ITEM	ITEM / DESCRIPTION	NOTES
1	POWDER COATED ALUMINUM ENCLOSURE	
2	KEY & LOCK	
3	2-1/2" BRASS SWIVEL	
4	VALVE CONTROLLER	
5	DC LATCHING SOLENOID	
6	1" PGV VALVE	
7	HANDLE	
8	ACCESS DOOR	
9	SAMPLING VALVE	OPTIONAL
10	WATER DIFFUSER FLOOR	NOT SHOWN
11	REMOVABLE PLATE	NOT SHOWN
12	STANDARD CONTROLLER HOLDER	

ENCLOSURE WIDTH APPROXIMATELY 8.5"

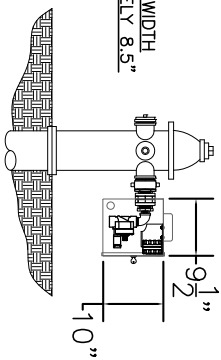

A FIRE HYDRANT
Scale: 3/8"=1'-0"

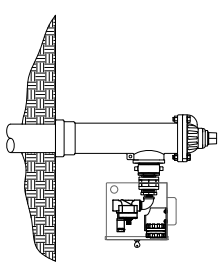

B #2 POST HYDRANT
Scale: 3/8"=1'-0"

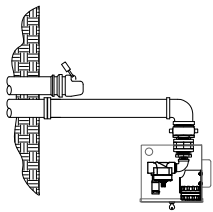

C #77 BLOW-OFF
Scale: 3/8"=1'-0"

NOTES:

1.) KUPFERLE ONLY OFFERS THE 1" FLUSHER WITH SAMPLING IN THE LARGER ENCLOSURE STYLE.

DD/MM/YY	ISSUED FOR REFERENCE
DATE	STATUS / REVISION

SHEET	1 OF 1	SCALE VARIES
#9700-A PORTABLE AUTOMATIC FLUSHER		

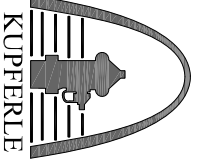
DRAWN BAM	 <p>2511 NORTH 9TH STREET ST. LOUIS, MO 63102 1-800-231-3990 FAX 314-231-2820 www.hydrants.com</p>
CHECKED DCL	
APPROVED DCL	
DATE 12/01/15	

Since 1857